

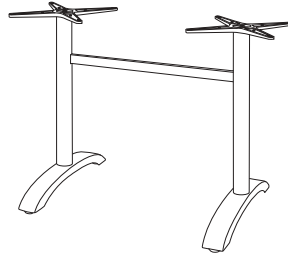

Eco-Fix Lateral Base



Length: 23.5"
 Width: 32"
 Height: 28"
 Space between mounts: 29.5"
 Weight:

Product Specifications

Product Description	Reference Number	Color	UPC Code 014306	Weight Each (lbs.)	Master Pack	Master Pack Volume (cu. ft)
Eco-Fix Lateral Base	US745009	Silver Gray	914169	19.34	1	1.77
	US745017	Black	914176	19.34	1	1.77

Features & Benefits Warranty: 2 Yrs.

- Specifically designed for indoor/outdoor hospitality and food service use.
- For use with Grosfillex 48" x 32" sizes.
- Heavy duty powder coated aluminum construction for weather resistance and structural integrity.
- Four adjustable leg levellers balance table on uneven surfaces.
- Easy to assemble.

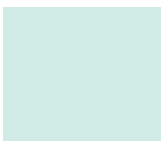

Silver Gray



Black



Eco-Fix Lateral Base

Spare Parts

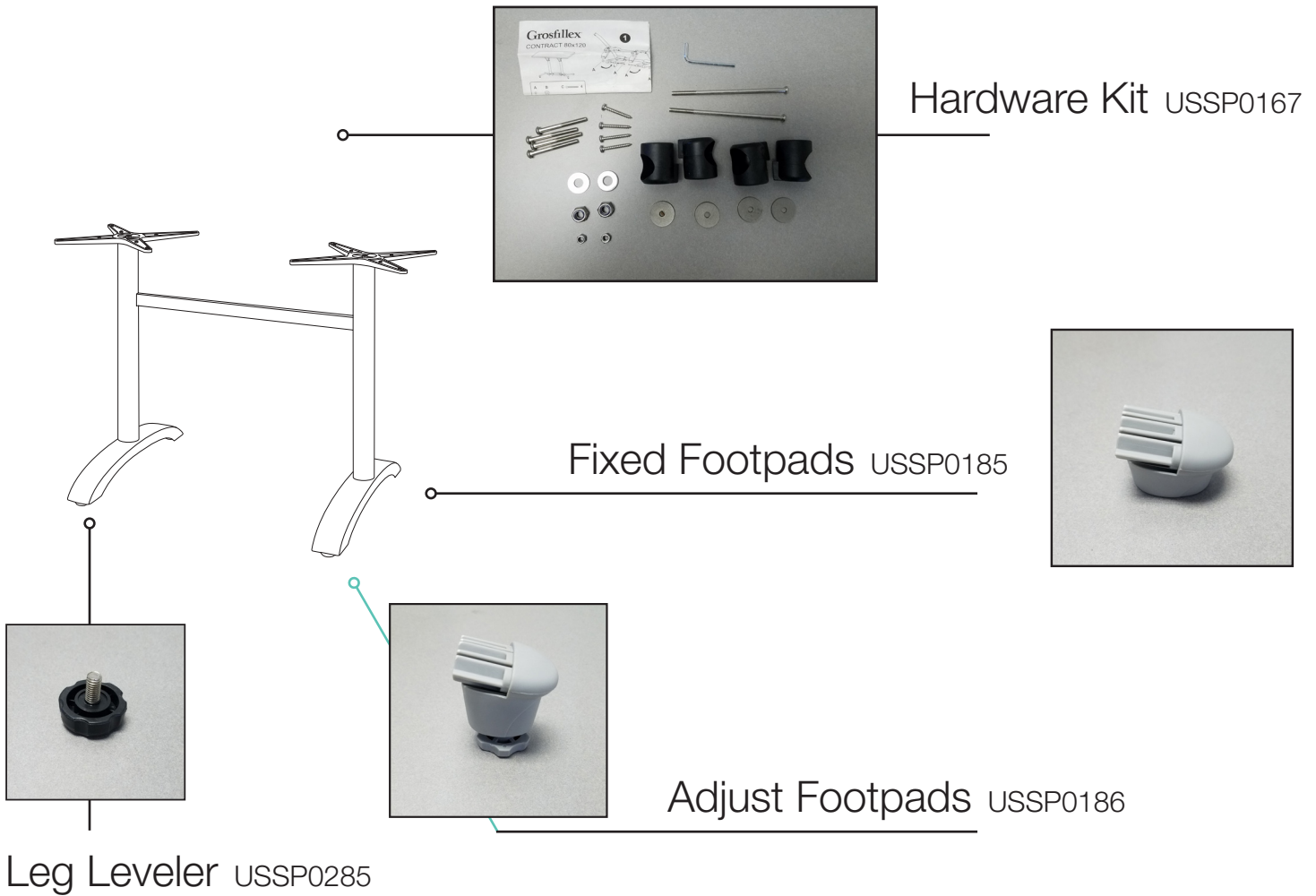

Reference	Description
USSP0167	HARDWARE KIT BOOMERANG
USSP0185	FIXED FOOTPADS-ALUM FLDG SILVER
USSP0186	ADJUST FOOTPADS-ALUM FLDG SILVER
USSP0285	LEG LEVELER X1 BOOM ECO SUN BAR

